

Cleaning the Flywheel and Flywheel Housing

Frequency: After 100 hours of use or every 6- 12 months.

Tools required: 5mm Allen key, 16mm wrench

Dust can build up inside the flywheel housing and on the flywheel blades. While not a major problem, the dust will accumulate over time and can alter the resistance range, generally making each resistance setting lighter. Follow the process below to open the flywheel housing and remove the accumulation of dust from the intake, the exhaust mesh and the flywheel blades.

1. Using just the 5mm key, loosen the 3 housing bolts.

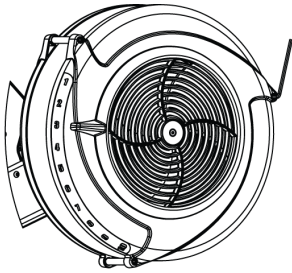

2. Remove the outer flywheel housing, while keeping the mesh strip in place in the inner housing.

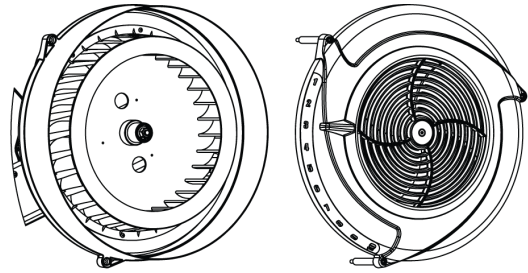

3. Release the mesh strip.

WARNING: Careful to not let the mesh spring open which can cause injury.

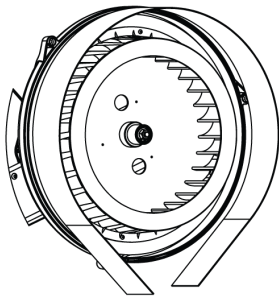

4. Using the 17mm wrench, undo the flywheel driveshaft nut and remove the flywheel.

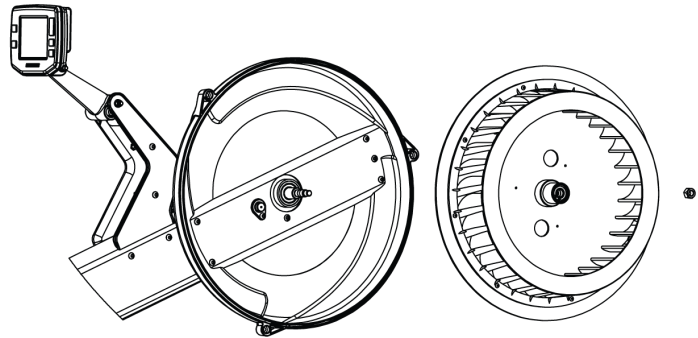

5. Clean flywheel, mesh strip, and the inner and outer housing of dust. Replace the flywheel and tighten driveshaft nut.

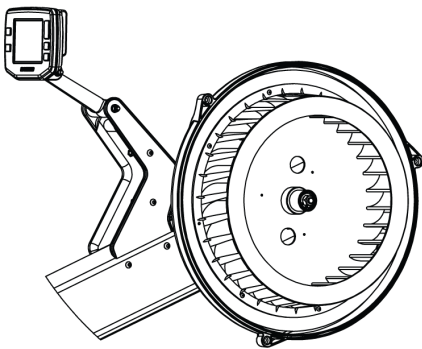

6. Insert the mesh strip into the slot in the inner housing overlapping the mesh at the bottom.

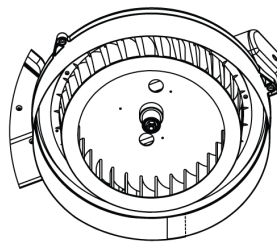

7. Replace outer cover and align overlap in mesh. Tighten bolts making sure the nut thread correctly onto the bolt before tightening.

